



© Jaguar Land Rover Limited
All rights reserved.

SECTION: 204-05

Discovery II - Air Suspension Height Sensor Connector Service Kit

AFFECTED VEHICLE RANGE:

Discovery Series II (LT)

VIN:

XA900000-4A828802

MARKETS:

All

CONDITION SUMMARY:

Situation: This bulletin is to provide notification of the introduction of a service repair kit for the air suspension height sensor electrical connector.

Cause: Air suspension height sensor connector damage would normally require the renewal of the entire wiring harness. The introduction of a short overlay harnesses including a new connector as a service repair kit is now available.

Action: Should any diagnostic trouble codes be present in the air suspension control module as a result of wiring harness problems, refer to the Service Procedure detailed in this bulletin to renew damaged harness section where appropriate.

PARTS:

YMQ503220

Overlay harness/connector

Quantity: 1

WARRANTY:



NOTE: Repair procedures are under constant review, and therefore times are subject to change; those quoted here must be taken as guidance only. Always refer to TOPIX to obtain the latest repair time.



NOTE: DDW requires the use of causal part numbers. Labor only claims must show the causal part number with a quantity of zero.

DESCRIPTION	SRO	TIME	CONDITION CODE	CAUSAL PART
Height sensor overlay harness installation - left-hand	64.36.89/27	0.40 hours	42	RQH100030
Height sensor overlay harness installation - right-hand	64.36.89/28	0.40 hours		



NOTE: Normal Warranty procedures apply.

SERVICE PROCEDURE:

If after diagnosis the height sensor requires replacement and the area of wiring damage is localized to the height sensor connector, this overlay harness should be used.

- 1 Disconnect the battery ground cable. For additional information, refer to Discovery II Workshop Manual Section 03, General Information - Electrical Precautions ().
- 2 Disconnect the damaged height sensor electrical connector.

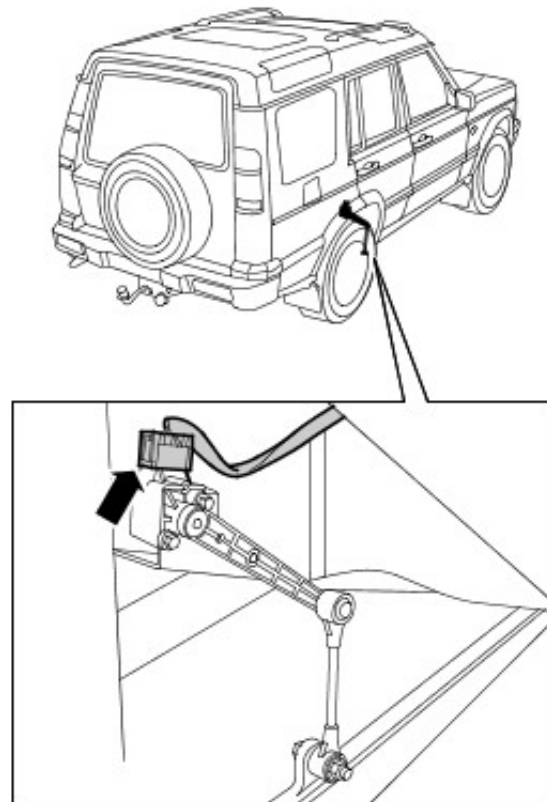

E81355

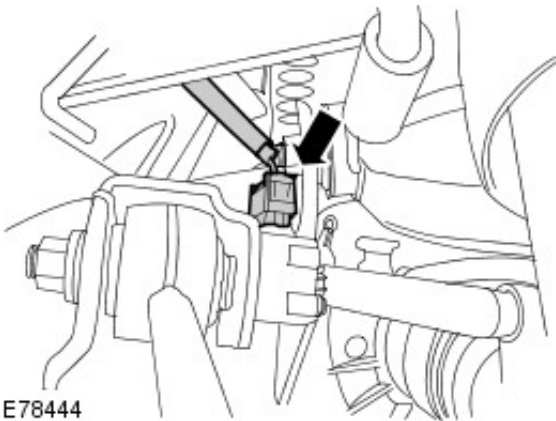

E78444

3Unclip a sufficient length of the wiring harness to allow easy access during the repair.

4Remove the wiring harness insulation as required.

5  **NOTE: It is advisable to cut only one of the three wires at a time and to stagger each joint to allow easier installation.**

 **NOTE: The colors of the overlay harness wires may vary.**

Cut the wire on the vehicle harness leading to cavity one of the height sensor connector in a suitable position and remove 10mm of insulation. (For connector location and pin identification, refer to the relevant connector, C0763/4, in the Connector Details section of the relevant Electrical Library).

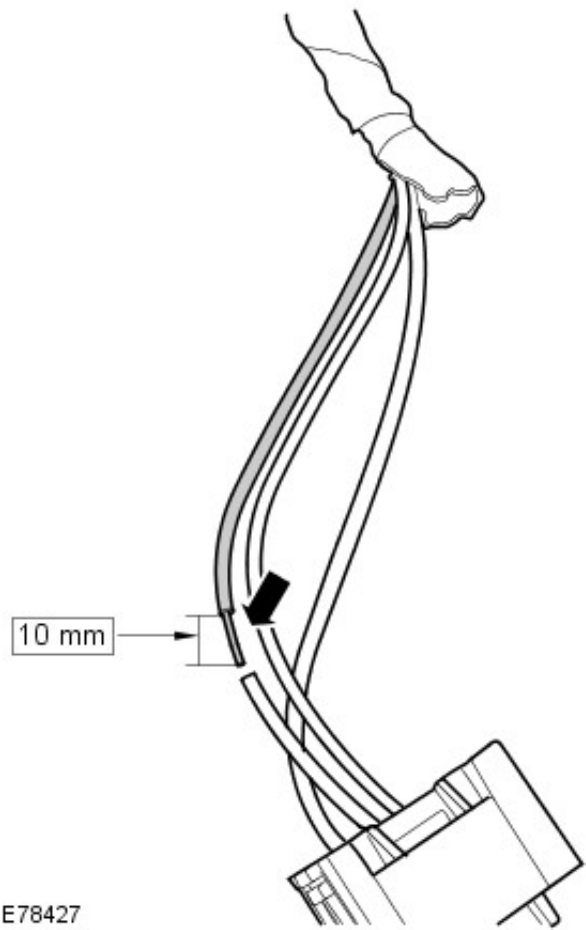

E78427

6 Slide over this wire a section of heat shrink sleeving.

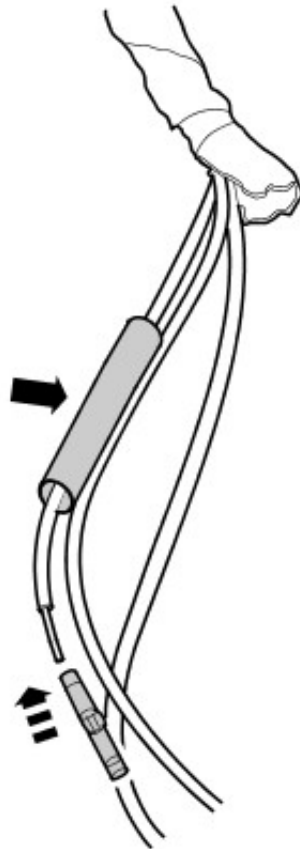

E78428

7 Using the inline connector supplied and the correct crimping tool set to the correct jaw size from the harness repair kit, crimp the connector to the wire.

8  **NOTE: The overlay harness should be**

cut so that there is no additional length added to overall length after the repair.

Select the appropriate wire on the overlay harness that also goes to cavity one of the new connector, cut to the correct length and remove 10mm of insulation.

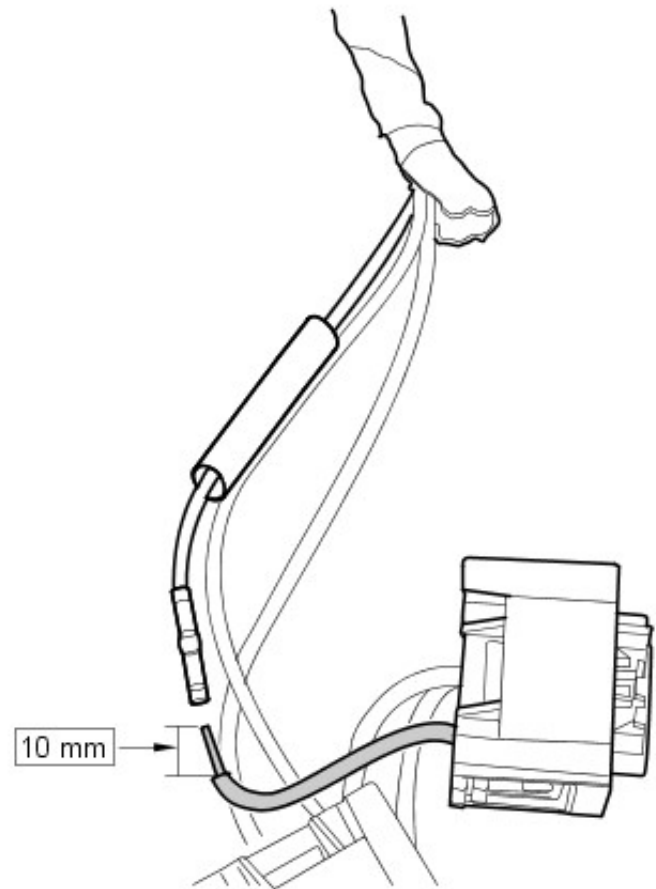

E78429

9 Insert the overlay wire into the connector and crimp in place.

10  **CAUTION: Care must be taken when using the heat gun to avoid damage to surrounding areas.**

Slide the heatshrink over the connector and using a hot air gun carefully apply the heat until the glue appears at both ends.

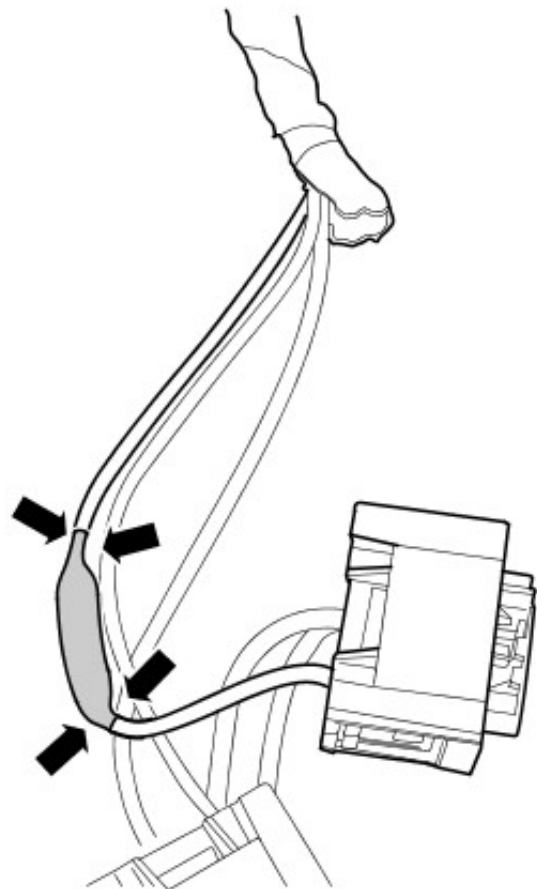

E78430

11 Carry out the same process for the wires in cavities four and five of the connector. (For connector location and pin identification, refer to the relevant connector, C0763/4, in the Connector Details section of the relevant Electrical Library).

12 Discard the damaged connector/section of harness.

13 Add suitable harness repair tape to the repaired area to within 10mm of the new connector to complete the repair.

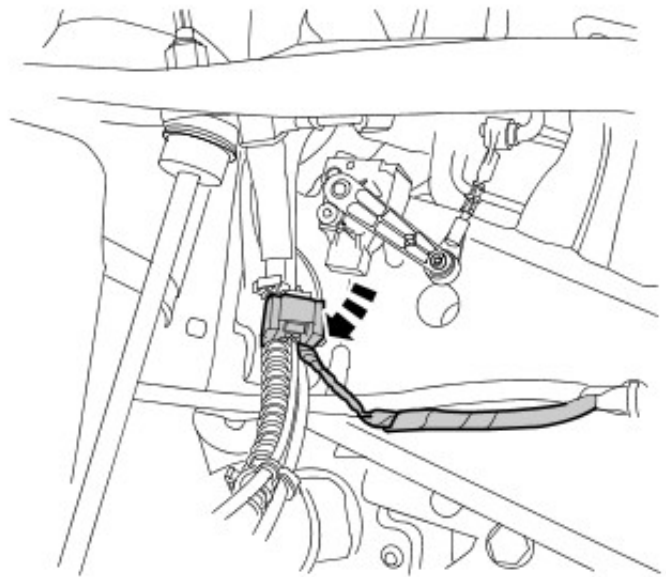

E78431

14 Correctly route/secure the harness and connect the new connector to the height sensor.

15 Connect the battery ground cable. For additional information, refer to Discovery II Workshop Manual Section 03, General Information - Electrical Precautions ().

16 Clear any DTCs logged in the air suspension control module and confirm correct operation of the system.